

ALERT SERVICE BULLETIN
Bell Helicopter **TEXTRON**

A Subsidiary of Textron Inc.

NO. 427-08-21

DATE April 08, 2008

PAGE 1

DATE
REV

MODEL AFFECTED: 427

SUBJECT: P3 FITTING-INSPECTION OF

HELICOPTERS AFFECTED: Model 427 helicopters serial number 56001 and subsequent and 58001 and subsequent.

COMPLIANCE: See vendor bulletin.

DESCRIPTION:

The purpose of this bulletin is to achieve complete distribution of the attached vendor bulletin to the current affected model distribution list on record by Bell Helicopter.

APPROVAL:

See vendor bulletin approval.

PRATT & WHITNEY CANADA
ALERT SERVICE BULLETIN

P&WC S.B. No. A28293R1

BULLETIN INDEX LOCATOR
72-11-00

TURBOSHAFT ENGINE
P3 FITTING - INSPECTION OF

MODEL APPLICATION

PW206B, PW206B2, PW206C, PW207C, PW207D, PW207K

Compliance: CATEGORY 3

Summary: It is possible that the P3 fitting located on the Reduction Gearbox (RGB) carbon seal housing may become obstructed by environmental debris. Inspect the P3 fitting to make sure sufficient airflow is present.

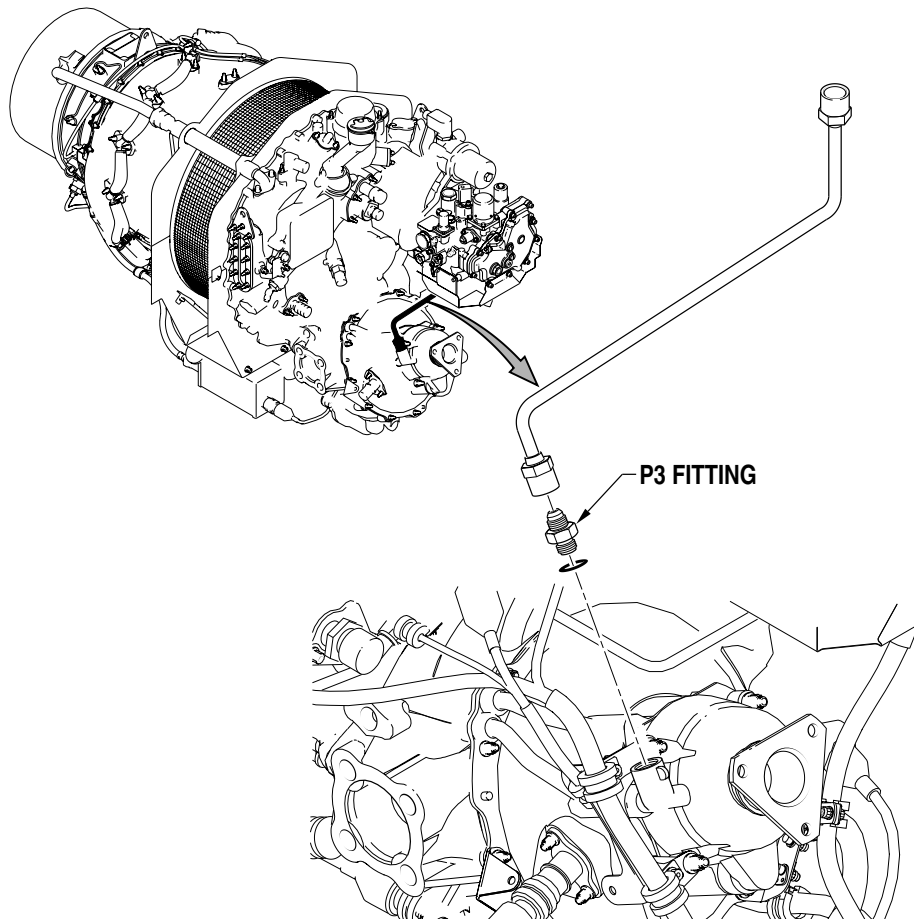

Jul 30/2007
Revision No. 1: Feb 11/2008

PW200-72-A28293
Cover Sheet

24-Hour Global Service

HELP DESK

Toll free where available (SIL GEN-027)

USA & CANADA..... 1-800-268-8000

International (IAC*)+8000-268-8000

* International Access Code

Other..... 1-450-647-8000

Fax..... 1-450-647-2888

Web Site..... www.pwc.ca

WARNING - PROPRIETARY RIGHTS & EXPORT CONTROLS NOTICE

This bulletin contains proprietary information of Pratt & Whitney Canada Corp. ("P&WC"), which P&WC provides in confidence and solely for the purposes of supporting engine certification and providing applicable information regarding the proper use, maintenance, inspection, repair, servicing and parts application of P&WC products and services, as directed therein. Neither this bulletin nor any information in it may be disclosed to others, or used for any other purpose, including, without limitation, to design, create, develop, reproduce, manufacture or derive any design, part, product, material, process, modification, configuration change or repair, or obtain FAA or other government approval to do so. Possession and use of this bulletin is also subject to the restrictions set out in P&WC's Technical Data Agreement (a copy of which may be obtained by contacting P&WC Technical Publications). The contents of this bulletin may be subject to export control laws. Unauthorized export or re-export of the bulletin, or parts thereof, is prohibited. By accepting and possessing this bulletin, you agree to be bound by the foregoing terms.

If a Government agency or department intends to disclose any information, written notice should be given to:

VP - Legal Services, Pratt & Whitney Canada Corp., 1000 Marie-Victorin (01BE5), Longueuil, Quebec J4G 1A1.



11 February 2008

P&WC S.B. No. A28293R1

REVISION TRANSMITTAL SHEET
TURBOSHAFT ENGINE MODEL PW200

SUBJECT: Pratt & Whitney Canada Service Bulletin No. PW200-72-A28293, Rev. No. 1, dated Feb 11/2008 (P&WC S.B. No. A28293R1) P3 FITTING - INSPECTION OF

Replace your existing copy of this service bulletin with the attached revised bulletin. Destroy the superseded copy.

Please retain this Revision Transmittal Sheet with the revised bulletin.

SUMMARY:

EFFECT OF REVISION ON PRIOR ACCOMPLISHMENT:

This revision is issued to:

- add additional engine models,
- change 400 hours TTSN to 200 hours TTSN for PW206B/B2 engines in paragraph 1.A,
- correct part number of packing in paragraph 2.D., and
- reformat the Accomplishment Instructions in paragraph 3.

NOTE: A black bar in the left margin indicates a change in that line of text or figure.

REVISION HISTORY:

Original Issue: Jul 30/2007
Revision No. 1: Feb 11/2008

PRATT & WHITNEY CANADA
ALERT SERVICE BULLETIN

P&WC S.B. No. A28293R1

TURBOSHAFT ENGINE
P3 FITTING - INSPECTION OF

1. Planning Information

A. Effectivity

PW206B Engines with more than 200 hours TTSN.
PW206B2 Engines with more than 200 hours TTSN.
PW206C Engines with more than 200 hours TTSN.
PW207C Engines with more than 200 hours TTSN.
PW207D Engines with more than 200 hours TTSN.
PW207K Engines with more than 200 hours TTSN.

B. Concurrent Requirements

None.

C. Reason

(1) Problem

Operation of the engine Fuel Management Module (FMM) may be affected by a restriction of P3 air.

(2) Cause

The RGB carbon seal housing and P3 fitting may become obstructed by environmental debris.

(3) Solution

Do a one time inspection of the P3 fitting to ensure sufficient airflow and no presence of debris. Remove and clean the RGB carbon seal housing, the P3 fitting and the transfer tube if debris is present.

D. Description

Do a one time inspection to make sure that there is sufficient airflow at the P3 fitting.

E. Compliance

CATEGORY 3 - P&WC recommends to do this service bulletin within 50 flight hours.

F. Approval

D.A.A. approved

G. Weight and Balance

None.

PRATT & WHITNEY CANADA
ALERT SERVICE BULLETIN

P&WC S.B. No. A28293R1

TURBOSHAFT ENGINE
P3 FITTING - INSPECTION OF

1. Planning Information (Cont'd)

H. Electrical Load Data

Not changed.

I. Software Accomplishment Summary

Not changed.

J. References

Applicable PW200 Technical Manuals

K. Publications Affected

Applicable PW200 Technical Manuals

L. Interchangeability and Intermixability of Parts

Interchangeability - Refer to Para. 2.D.

Intermixability - Not changed.

2. Material Information

A. Industry Support Information

Not applicable.

B. Material - Cost and Availability

You can get the procurable parts listed in Para. 2.D. from any Pratt & Whitney Canada Parts Distribution Center.

The estimated total cost of new parts needed to replace old parts is \$Quote (US, 2008).

C. Manpower

Once you have access to the part, an estimate of 2.0 man-hours is required to include this service bulletin at maintenance.

PRATT & WHITNEY CANADA
ALERT SERVICE BULLETIN

P&WC S.B. No. A28293R1

TURBOSHAFT ENGINE
P3 FITTING - INSPECTION OF

D. Material Necessary for Each Engine

The quantity of materials listed in this section is on a per engine basis.

<u>New P/N</u>	<u>Keyword</u>	<u>Old P/N</u>	<u>Qty</u>	<u>Est. Unit List Price (\$US, 2008)</u>	<u>Instructions Disposition</u>
Standard Replacement Parts					
AS3208-04	Preformed Packing (P3 fitting)	AS3208-04	1	0.61	
AS3209-152	Preformed Packing (No. 8 housing cover)	AS3209-152	1	5.93	
AS3209-114	Preformed Packing (transfer tube)	AS3209-114	2	1.43	
AS3209-012	Preformed Packing (transfer tube)	AS3209-012	2	0.99	

E. Reidentified Parts

None.

F. Tooling - Price and Availability

Not applicable.

3. Accomplishment Instructions

- A. Remove the P3 fitting from the No. 8 Brg. carbon seal housing and discard packing P/N AS3208-04 (Ref. Maintenance Manual 72-11-00).
- B. Do an inspection of the port, fitting and tube for debris.
- C. Do a dry motoring cycle for 10 seconds (respecting the starter motor limitation) and check for airflow with your hand.
- D. If debris is found or there is insufficient airflow, do as follows:
 - (1) Remove and clean the No. 8 Brg. carbon seal housing (Ref. Maintenance Manual 72-11-00).
 - (2) Install the No. 8 Brg. carbon seal housing with new packing P/N AS3209-012, AS3209-114, and AS3209-152.

PRATT & WHITNEY CANADA
ALERT SERVICE BULLETIN

P&WC S.B. No. A28293R1

TURBOSHAFT ENGINE
P3 FITTING - INSPECTION OF

3. Accomplishment Instructions (Cont'd)

- E. Install the P3 fitting on the No. 8 Brg. carbon seal housing with new packing P/N AS3208-04.
- F. Write accomplishment of P&WC S.B. No. 28293 in the applicable engine module log book.

4. Appendix

- A. Complete the inspection results form and return to P&WC (Ref. Fig. 1).

PRATT & WHITNEY CANADA
ALERT SERVICE BULLETIN

P&WC S.B. No. A28293R1

TURBOSHAFT ENGINE
P3 FITTING - INSPECTION OF

TO: P&WC PW200 SERVICE ENGINEERING FAX NO.: 450-647-9597	FROM: NAME: _____ COMPANY: _____ FAX NO.: _____
<i>Engine S/N</i>	/ / / / / / / / / /
Date of SB Inc.	
TTSN	
TTSO	
Findings Check one	Clogged
	Dirty
	Clean
REMARKS: _____ _____ _____ _____ _____ _____ _____	

C123533

Inspection Results
 Figure 1