

**TECHNICAL BULLETIN**  
**Bell Helicopter** **TEXTRON**

A Subsidiary of Textron Inc.

No. 206L-02-210

Date Dec. 06, 02

Page 1 of 7

DATE
REV

**MODEL AFFECTED:** 206L, L1, L3

**SUBJECT:** TRANSMISSION INPUT PINION STOPPER 14-141K, INTRODUCTION OF.

**HELICOPTERS AFFECTED:** 206L, S/N 45001 through 45153, and 46601 through 46617;  
206L-1, S/N 45154 through 45790  
206L3, S/N 51001 through 51612.

**COMPLIANCE:** At Customer's Option

**DESCRIPTION:**

This Technical Bulletin introduces a stopper 14-141K to replace the existing cork plug used in the transmission input pinions 206-040-020-009/-103/ and-105. The stopper 14-141K is a rubber plug and will improve the sealing of the input pinion cavity.

**APPROVAL:**

The engineering aspects of this bulletin are Transport Canada approved.

**MANPOWER:**

No additional manpower is required when you do this bulletin during overhaul.

**MATERIALS:**

**Required Material:**

The following material is required for the accomplishment of this bulletin and may be obtained through your Bell Helicopter Textron Supply Center.

<u>Part Number</u>	<u>Nomenclature</u>	<u>Quantity</u>
14-141K	STOPPER	1

**Consumable Material:**

The following material is required to accomplish this bulletin, however this material is considered consumable (bench stock) material and may not require ordering depending on the operator's consumable material stock levels. This material may be obtained through your Bell Helicopter Textron Supply Center.

<u>Part Number</u>	<u>Nomenclature</u>	<u>Quantity</u>	<u>Reference</u>
MILS8784CLB2,3.5OZ	SEALANT	1	C-328
471,YEL,.75 WIDE	TAPE	1	(NOTE 1)

**NOTE:**

1. Equivalent plastic tape may be used as an alternate.

**SPECIAL TOOLS:**

None required

**ELECTRICAL LOAD DATA:**

Not affected

**REFERENCES:**

BHT-206L-CR&O, Reissue, 18 June 1994.

Chapter 63, Main rotor drive system.

**PUBLICATIONS AFFECTED:**

BHT-206L-SERIES-IPB, Revision 2, 8 March 1999.

Chapter 63, Main rotor drive.

BHT-206L-CR&O, Reissue, 18 June 1994.

Chapter 63, Main rotor drive system.

**ACCOMPLISHMENT INSTRUCTIONS:**

**INSTALLATION INSTRUCTIONS:**

1. Remove cork plug (206L-CR&O, Chapter 63).
2. Prepare workaid (# 1, Figure 4).
3. Cover the transmission input pinion with tape 471,YEL,.75 WIDE (View A, Figure 1).
4. Apply sealant (C-328) to the Stopper (View B) and the transmission input pinion (View C).
5. Use workaid # 1 to press the stopper (2, Figure 2) into input pinion (1).
6. For configuration purpose with this stopper installed, once this Technical Bulletin is completed the input pinion 206-040-020-105 is equivalent to a 206-040-020-109.

**REMOVAL INSTRUCTIONS:**

1. Prepare workaids (# 2 and 3, Figure 4).
2. Use workaids # 2 and 3 to remove the stopper from the input pinion (Figure 3). Discard removed stopper.

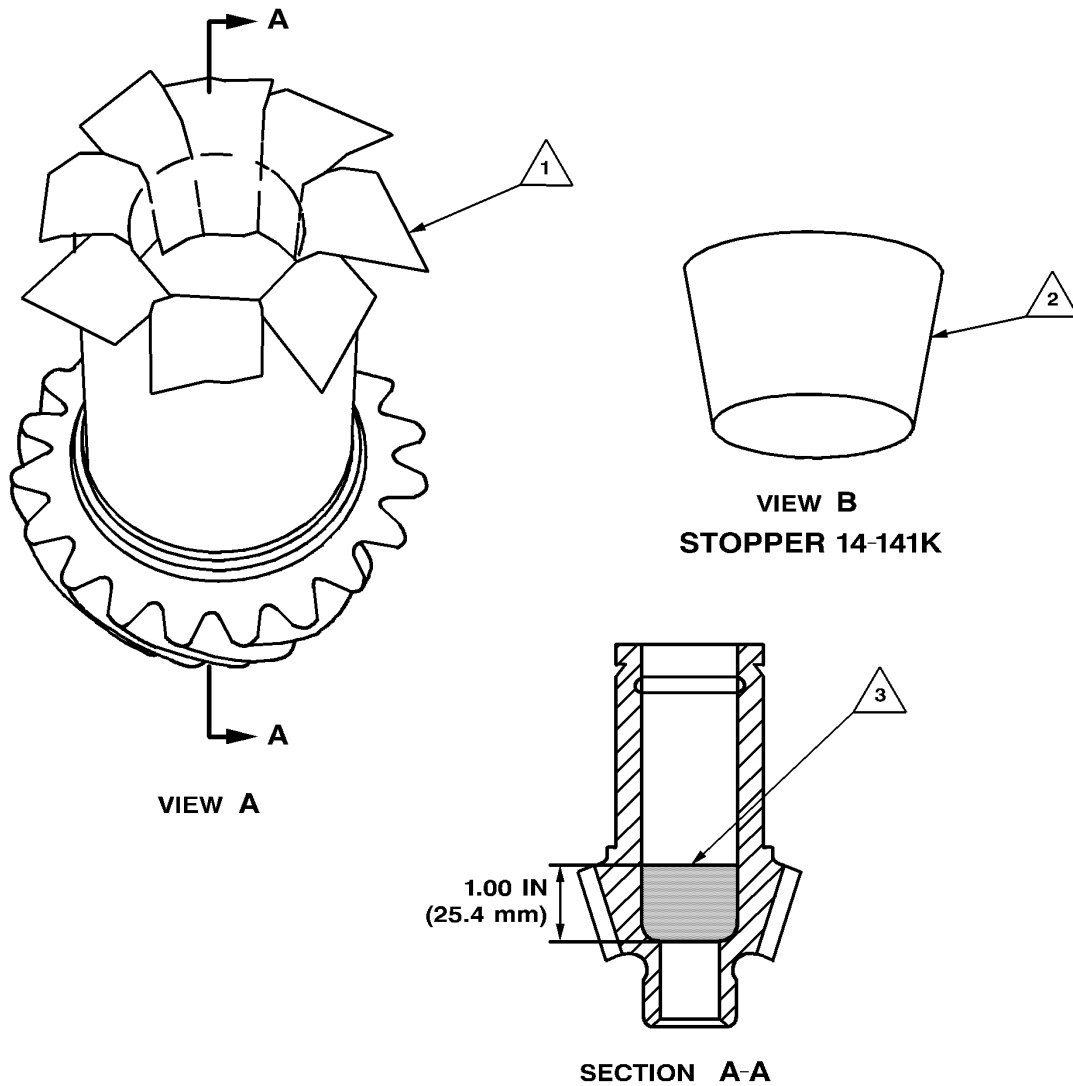

**NOTES**

- ① Cover with strips of tape beyond the machined groove.
- ② Apply sealant (C-328) to the tapered surface of the stopper 14-141K.
- ③ Apply sealant (C-328) to the shaded area of the transmission input pinion.

T02529001

**Figure 1. Installation Preparations**

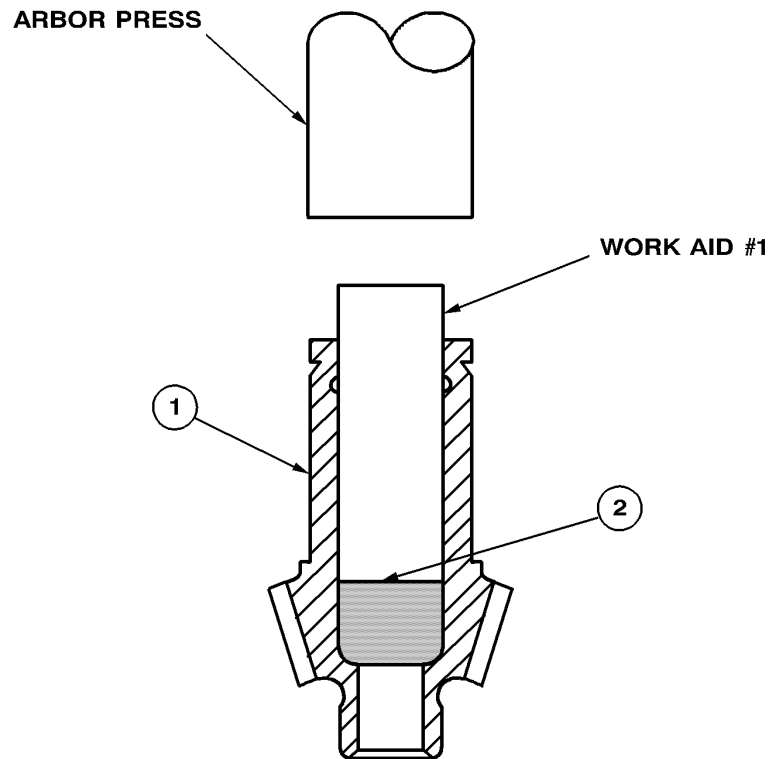

**LEGEND**

- 1. Transmission input pinion (206-040-020-009/-103/-105)
- 2. Stopper (14-141K)

**Figure 2. Stopper installation instructions**

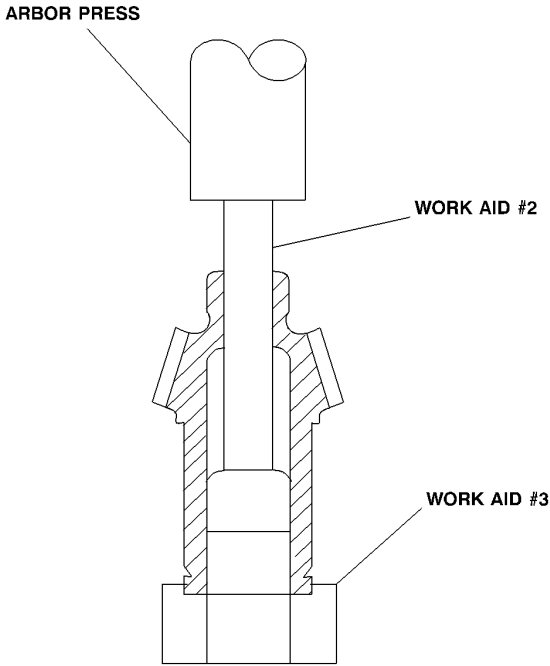

STOPPER REMOVAL

Figure 3. Stopper removal instructions

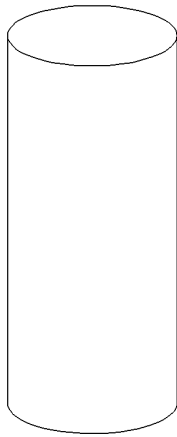

**WORKAID  
(ITEM #1)**

**MATERIAL: ALUMINUM  
O.D.: 1.485 IN (37.72 mm)  
LENGTH: 4.00 IN (101.6 mm)**

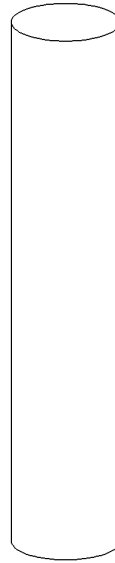

**WORKAID  
(ITEM #2)**

**MATERIAL: ALUMINUM  
O.D.: 0.860 IN (22 mm)  
LENGTH: 6.10 IN (155 mm)**

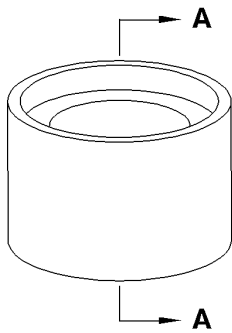

**WORKAID  
(ITEM #3)**

**MATERIAL: ALUMINUM  
O.D.: 2.5 IN (63 mm)**

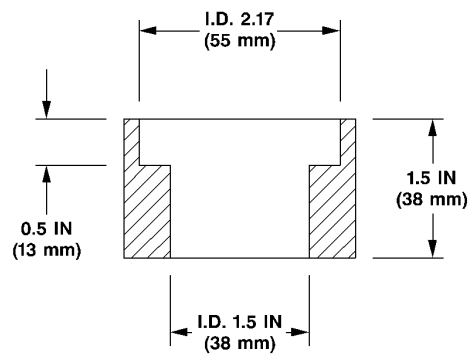

**SECTION A-A**

T02529004

**Figure 4. Workaids**