

TECHNICAL BULLETIN
Bell Helicopter **TEXTRON**

A Subsidiary of Textron Inc.

No. 212-02-188

Date 12-13-02

Page 1 of 4

DATE
REV

MODEL AFFECTED: 212

SUBJECT: TRANSMISSION OIL COOLER LINES P/N 412-040-243-101 & 412-040-244-101, INTRODUCTION OF

HELICOPTERS AFFECTED: All model 212 helicopters.

[Model 212 helicopters serial number 35104 and subsequent will have the intent of this bulletin accomplished prior to delivery]

COMPLIANCE: At Customer's Option

DESCRIPTION:

Bell Helicopters is introducing CRES oil cooler lines to reduce corrosion and fatigue related damage. Concurrently, the retention clamps are to be replaced.

APPROVAL:

The engineering design aspects of this bulletin are FAA/DER approved.

MANPOWER:

Approximately 2.0 man-hours are required to complete this bulletin. Man-hours are based on hands-on time, and may vary with personnel and facilities available.

MATERIALS:

Required Material:

The following material is required for the accomplishment of this bulletin and may be obtained through your Bell Helicopter Textron Supply Center.

<u>Part Number</u>	<u>Nomenclature</u>	<u>Quantity</u>
412-040-243-101	Tube Assembly	1
412-040-244-101	Tube Assembly	1
MS21919WCG10	Clamp	4

SPECIAL TOOLS:

None required

WEIGHT AND BALANCE:

Not affected.

ELECTRICAL LOAD DATA:

Not affected

REFERENCES:

BHT-212-IPC Illustrated Parts Breakdown
BHT-212-MM Maintenance Manual

PUBLICATIONS AFFECTED:

BHT-212-IPC Illustrated Parts Breakdown

ACCOMPLISHMENT INSTRUCTIONS:

1. Drain oil from cooling system.
2. Remove clamps P/N MS21919WDG (Figure 1, Items 1). Retain attaching hardware for reuse or replace with similar type as required.
3. Remove tubes P/N 212-040-234-001 (Item 2) and P/N 212-040-233-001 (Item 3).

CAUTION

The oil tubes must be positioned to ensure they are not loaded in any direction.

4. Install the replacement CRES oil tubes P/N 412-040-244-101 (Item 2) and P/N 412-040-243-101 (Item 3) leaving the attaching tube nuts loose at this time.

CAUTION

When applying torque (200 in lbs.) to the tube nuts, ensure a directional load is not induced.

5. Tighten tube nuts on the replacement tubes (Items 2 & 3). If you suspect a load has occurred, loosen the tube nuts and reapply the torque, ensuring a twisting or bending load has not been induced in the tubes.

CAUTION

It is necessary to maintain the "no load" condition when tightening the clamps.

6. Install the replacements clamps P/N MS21919WCG10 (Items 1) as indicated in Figure 1. Oil lines (Items 2 & 3) retained by the clamps (Items 1) must be installed without applying a bending load.
7. Replenish previously drained oil, accomplish ground run and leak check procedures.
8. Make entry in helicopter historical records indicating compliance with this Technical Bulletin.

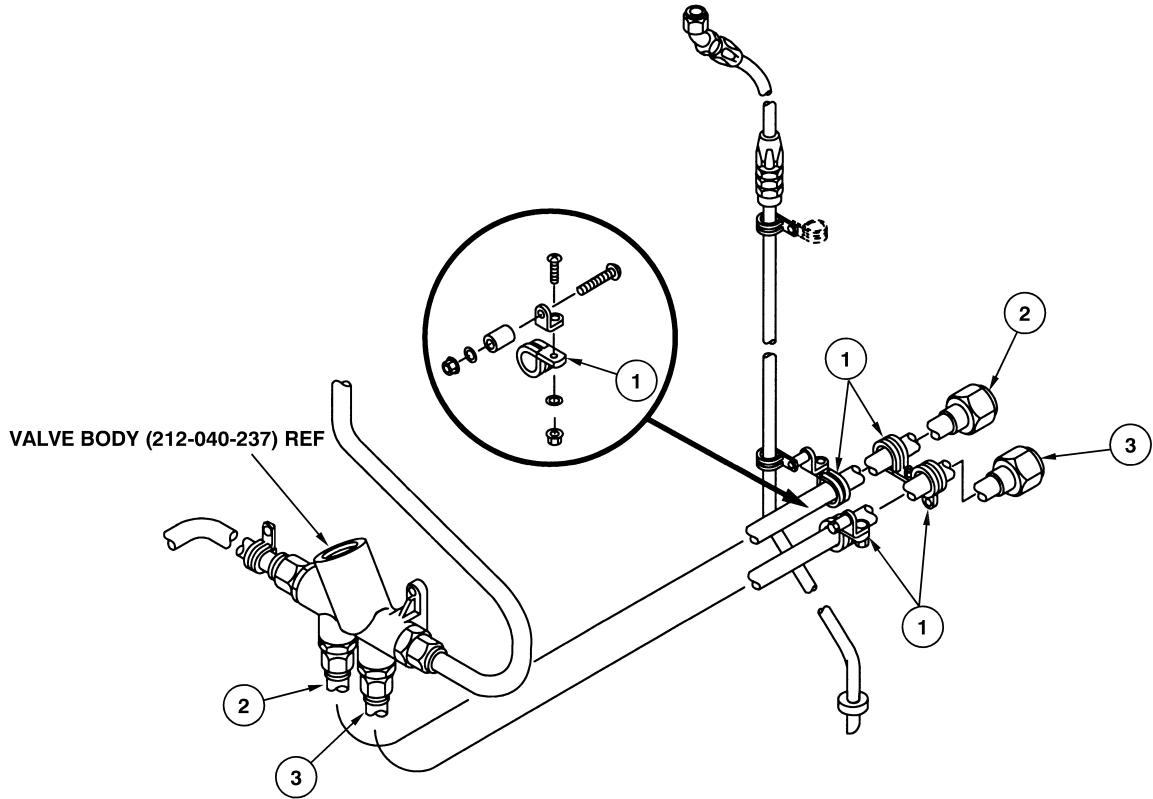

Figure 1. Transmission Oil Cooler Lines